

Identification Code: VE4-275-STST

Meeting the requirements of Annex ZA, EN 845-1:2013 +A1:2016

Description of Use:

Symmetrical wall tie classed as type 4 light duty housing tie used to connect two leaves of a cavity wall from 126-150mm.

Testing Body: Lucideon Ltd
Queens Road
Penkull
Stoke on Trent
ST4 7QL

Notification Body No: 1289

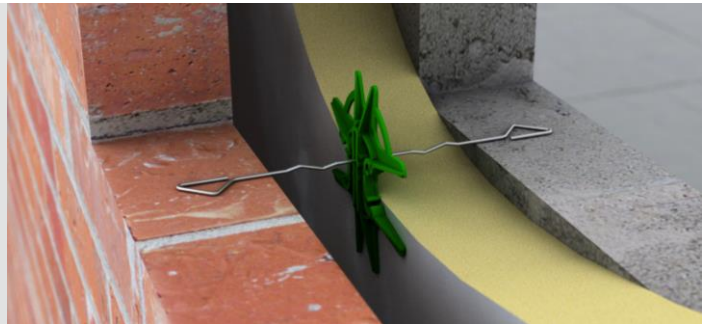

Performance:

Tensile Load Capacity:	1640N
Compressive Load Capacity:	380N
Displacement at $\frac{1}{3}$ Load: Tension:	0.91mm
Displacement at $\frac{1}{3}$ Load: Compression:	0.27mm
Water Shedding Capacity:	Resistant
Durability:	Material coating reference 3
Dangerous Substance:	N/A
Minimum Embedment:	62.5mm
Minimum Mortar Joint:	10mm

Authorised Signature



Philip Travis, Managing Director
21st March 2023

