

Identification Code: VW3-060-STST

Meeting the requirements of Annex ZA, EN 845-1:2003+A1:2008 Bed Joint Reinforcement defined in 4.2.2 of the standard

Description of Use:

Asymmetrical wall tie used to connect new masonry cladding to cast in or surface

Testing Body: Lucideon Ltd
Queens Road
Penkull
Stoke on Trent
ST4 7QL

Notification Body No: 1289

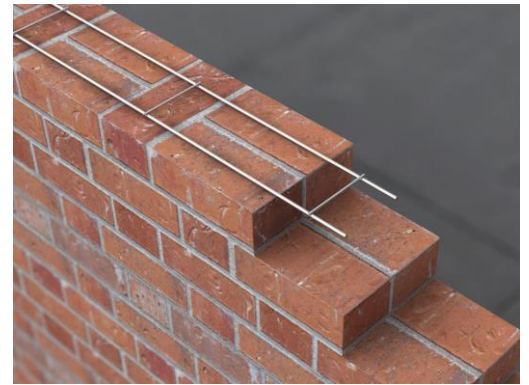

Performance:

Shear Load Capacity:	2060N
Width:	60mm +/-1.5mm
Profile Height:	3.5mm +/- 0.4mm
Longitudinal Wire Size:	3.0mm +/- 0.1mm
Cross Wire Size:	2.5mm +/- 0.1mm
Pitch of Cross Wires:	450mm +/- 3.0%
Characteristic Yield Strength:	500N/mm ²
Bond Strength:	3060N
Lap Strength:	225mm
Shear Load Capacity Welds:	2988N
Ductility:	Normal
Minimum Mortar Joint:	R3 (stainless steel)
Dangerous Substances:	None

**UK
CA**

Authorised Signature



Philip Travis, Managing Director

21st March 2023