

## Identification Code: VW5-150-STST

Meeting the requirements of Annex ZA, EN 845-1:2003+A1:2008 Bed Joint Reinforcement defined in 4.2.2 of the standard

### Description of Use:

Asymmetrical wall tie used to connect new masonry cladding to cast in or surface

**Testing Body:** Lucideon Ltd  
Queens Road  
Penkull  
Stoke on Trent  
ST4 7QL

**Notification Body No:** 1289

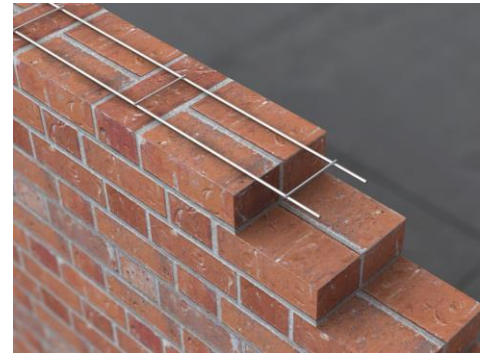

### Performance:

<b>Shear Load Capacity:</b>	2700mm +/- 1.5%
<b>Width:</b>	150mm +/- 1.5mm
<b>Profile Height:</b>	5.5mm +/- 0.4mm
<b>Longitudinal Wire Size:</b>	5.0mm +/- 0.1mm
<b>Cross Wire Size:</b>	2.5mm +/- 0.1mm
<b>Pitch of Cross Wires:</b>	450mm +/- 3.0%
<b>Characteristic Yield Strength:</b>	500N/mm <sup>2</sup>
<b>Bond Strength:</b>	7010N
<b>Lap Strength:</b>	225mm
<b>Shear Load Capacity Welds:</b>	3172N
<b>Ductility:</b>	Normal
<b>Minimum Mortar Joint:</b>	R3 (stainless steel)
<b>Dangerous Substances:</b>	None

**UK  
CA**

Authorised Signature



Philip Travis, Managing  
Director

21<sup>st</sup> March 2023